



P# 71384
NB

MEMO OF REVIEW FOR CORRECTNESS AND COMPLETION

In accordance with this community's participation in the National Flood Insurance Program's Community Rating System, all FEMA Elevation Certificates must be correct and complete. The attached Certificate has some incorrect items which are noted here.

SECTION A - PROPERTY INFORMATION			For Insurance Company Use:	
A1. Building Owner's Name			Policy Number	
A2. Building Street Address (Including Apt., Unit, Suite, and/or Bldg. No.) or P.O. Route and Box No.			Company NAIC Number	
City	State	ZIP Code		
A3. Property Description (Lot and Block Numbers, Tax Parcel Number, Legal Description, etc.)				
A4. Building Use (e.g., Residential, Non-Residential, Addition, Accessory, etc.) _____				
A5. Latitude/Longitude: Lat. _____ Long. _____			Horizontal Datum: <input type="checkbox"/> NAD 1927 <input type="checkbox"/> NAD 1983	
A6. Attach at least 2 photographs of the building if the Certificate is being used to obtain flood insurance.				
A7. Building Diagram Number 1B				
A8. For a building with a crawl space or enclosure(s), provide:			A9. For a building with an attached garage, provide:	
a) Square footage of crawl space or enclosure(s) _____ sq ft			a) Square footage of attached garage _____ sq ft	
b) No. of permanent flood openings in the crawl space or enclosure(s) walls within 1.0 foot above adjacent grade _____			b) No. of permanent flood openings in the attached garage walls within 1.0 foot above adjacent grade _____	
c) Total net area of flood openings in A8.b _____ sq in			c) Total net area of flood openings in A9.b _____ sq in	
d) Engineered flood openings? <input type="checkbox"/> Yes <input type="checkbox"/> No			d) Engineered flood openings? <input type="checkbox"/> Yes <input type="checkbox"/> No	

SECTION B - FLOOD INSURANCE RATE MAP (FIRM) INFORMATION

B1. NFIP Community Name & Community Number		B2. County Name		B3. State	
B4. Map/Panel Number	B5. Suffix	B6. FIRM Index Date	B7. FIRM Panel Effective/Revised Date	B8. Flood Zone(s)	B9. Base Flood Elevation(s) (Zone AO, use base flood depth)

- B10. Indicate the source of the Base Flood Elevation (BFE) data or base flood depth entered in Item B9.
 FIS Profile FIRM Community Determined Other (Describe) _____
- B11. Indicate elevation datum used for BFE in Item B9: NGVD 1929 NAVD 1988 Other/Source: _____
- B12. Is the building located in a Coastal Barrier Resources System (CBRS) area or Otherwise Protected Area (OPA)? Yes No
 Designation Date _____ CBRS OPA

SECTION C - BUILDING ELEVATION INFORMATION (SURVEY REQUIRED)

- C1. Building elevations are based on: Construction Drawings* Building Under Construction* Finished Construction
 *A new Elevation Certificate will be required when construction of the building is complete.
- C2. Elevations -- Zones A1-A30, AE, AH, A (with BFE), VE, V1-V30, V (with BFE), AR, AR/A, AR/AE, AR/A1-A30, AR/AH, AR/AO. Complete items C2.a-h below according to the building diagram specified in Item A7.
 Benchmark Utilized _____ Vertical Datum _____
- Indicate elevation datum used for the elevations in items a) through h) below: NGVD 1929 NAVD 1988 Other/Source: _____

COMMENTS:

CORRECTED A7

Date of Review: **9/17/21** Community Official: *[Signature]*

All elevation certificates shall be maintained by the community and copies with the attached memo made available upon request.

9-A-11 71384 9/17/21
 OMB No. 1660-0008
 Expiration Date: November 30, 2022

ELEVATION CERTIFICATE

Important: Follow the instructions on pages 1-9.

Copy all pages of this Elevation Certificate and all attachments for (1) community official, (2) insurance agent/company, and (3) building owner.

SECTION A - PROPERTY INFORMATION				FOR INSURANCE COMPANY USE	
A1. Building Owner's Name Janet Wilson Clore				Policy Number:	
A2. Building Street Address (including Apt., Unit, Suite, and/or Bldg. No.) or P.O. Route and Box No. 358 Pitch Landing Road				Company NAIC Number:	
City Conway		State South Carolina		ZIP Code 29527	
A3. Property Description (Lot and Block Numbers, Tax Parcel Number, Legal Description, etc.) PIN#381-03-01-0001					
A4. Building Use (e.g., Residential, Non-Residential, Addition, Accessory, etc.) <u>Residential</u>					
A5. Latitude/Longitude: Lat. <u>33°48'26.35"</u> Long. <u>79°03'41.31"</u> Horizontal Datum: <input type="checkbox"/> NAD 1927 <input checked="" type="checkbox"/> NAD 1983					
A6. Attach at least 2 photographs of the building if the Certificate is being used to obtain flood insurance.					
A7. Building Diagram Number <u>1A</u>					
A8. For a building with a crawlspace or enclosure(s):					
a) Square footage of crawlspace or enclosure(s) <u>843.28</u> sq ft					
b) Number of permanent flood openings in the crawlspace or enclosure(s) within 1.0 foot above adjacent grade <u>11</u>					
c) Total net area of flood openings in A8.b <u>2448.00</u> sq in					
d) Engineered flood openings? <input type="checkbox"/> Yes <input checked="" type="checkbox"/> No					
A9. For a building with an attached garage:					
a) Square footage of attached garage <u>N/A</u> sq ft					
b) Number of permanent flood openings in the attached garage within 1.0 foot above adjacent grade <u>N/A</u>					
c) Total net area of flood openings in A9.b <u>N/A</u> sq in					
d) Engineered flood openings? <input type="checkbox"/> Yes <input checked="" type="checkbox"/> No					
SECTION B - FLOOD INSURANCE RATE MAP (FIRM) INFORMATION					
B1. NFIP Community Name & Community Number Horry County 450104			B2. County Name Horry		B3. State South Carolina
B4. Map/Panel Number 45051C 0512	B5. Suffix H	B6. FIRM Index Date 09-17-2003	B7. FIRM Panel Effective/ Revised Date 08-23-2003	B8. Flood Zone(s) AE	B9. Base Flood Elevation(s) (Zone AO, use Base Flood Depth) 9
B10. Indicate the source of the Base Flood Elevation (BFE) data or base flood depth entered in Item B9: <input type="checkbox"/> FIS Profile <input checked="" type="checkbox"/> FIRM <input type="checkbox"/> Community Determined <input type="checkbox"/> Other/Source: _____					
B11. Indicate elevation datum used for BFE in Item B9: <input checked="" type="checkbox"/> NGVD 1929 <input type="checkbox"/> NAVD 1988 <input type="checkbox"/> Other/Source: _____					
B12. Is the building located in a Coastal Barrier Resources System (CBRS) area or Otherwise Protected Area (OPA)? <input type="checkbox"/> Yes <input checked="" type="checkbox"/> No Designation Date: _____ <input type="checkbox"/> CBRS <input type="checkbox"/> OPA					

ELEVATION CERTIFICATE

OMB No. 1660-0008
Expiration Date: November 30, 2022

IMPORTANT: In these spaces, copy the corresponding information from Section A.			FOR INSURANCE COMPANY USE	
Building Street Address (including Apt., Unit, Suite, and/or Bldg. No.) or P.O. Route and Box No. 358 Pitch Landing Road			Policy Number:	
City Conway	State South Carolina	ZIP Code 29527	Company NAIC Number	

SECTION C – BUILDING ELEVATION INFORMATION (SURVEY REQUIRED)

C1. Building elevations are based on: Construction Drawings* Building Under Construction* Finished Construction
 *A new Elevation Certificate will be required when construction of the building is complete.

C2. Elevations – Zones A1–A30, AE, AH, A (with BFE), VE, V1–V30, V (with BFE), AR, AR/A, AR/AE, AR/A1–A30, AR/AH, AR/AO.
 Complete Items C2.a–h below according to the building diagram specified in Item A7. In Puerto Rico only, enter meters.
 Benchmark Utilized: SC VRS Vertical Datum: NGVD1929

Indicate elevation datum used for the elevations in items a) through h) below.
 NGVD 1929 NAVD 1988 Other/Source: _____

Datum used for building elevations must be the same as that used for the BFE.

		Check the measurement used.
a) Top of bottom floor (including basement, crawlspace, or enclosure floor)	9.6	<input checked="" type="checkbox"/> feet <input type="checkbox"/> meters
b) Top of the next higher floor	13.4	<input checked="" type="checkbox"/> feet <input type="checkbox"/> meters
c) Bottom of the lowest horizontal structural member (V Zones only)	N/A	<input checked="" type="checkbox"/> feet <input type="checkbox"/> meters
d) Attached garage (top of slab)	N/A	<input checked="" type="checkbox"/> feet <input type="checkbox"/> meters
e) Lowest elevation of machinery or equipment servicing the building (Describe type of equipment and location in Comments)	N/A	<input checked="" type="checkbox"/> feet <input type="checkbox"/> meters
f) Lowest adjacent (finished) grade next to building (LAG)	9.2	<input checked="" type="checkbox"/> feet <input type="checkbox"/> meters
g) Highest adjacent (finished) grade next to building (HAG)	10.7	<input checked="" type="checkbox"/> feet <input type="checkbox"/> meters
h) Lowest adjacent grade at lowest elevation of deck or stairs, including structural support	9.6	<input checked="" type="checkbox"/> feet <input type="checkbox"/> meters

SECTION D – SURVEYOR, ENGINEER, OR ARCHITECT CERTIFICATION

This certification is to be signed and sealed by a land surveyor, engineer, or architect authorized by law to certify elevation information. I certify that the information on this Certificate represents my best efforts to interpret the data available. I understand that any false statement may be punishable by fine or imprisonment under 18 U.S. Code, Section 1001.

Were latitude and longitude in Section A provided by a licensed land surveyor? Yes No Check here if attachments.

Certifier's Name Ray R. Eshelman		License Number 22753		
Title PLS				
Company Name Palmetto Corp of Conway				
Address 3873 Hwy 701 N				
City Conway	State South Carolina	ZIP Code 29526		
Signature 	Date 09-13-2021	Telephone (843) 716-6021	Ext.	

Copy all pages of this Elevation Certificate and all attachments for (1) community official, (2) insurance agent/company, and (3) building owner.

Comments (including type of equipment and location, per C2(e), if applicable)
 C2(e). No Equipment currently servicing dwelling.

ELEVATION CERTIFICATE

OMB No. 1660-0008
Expiration Date: November 30, 2022

IMPORTANT: In these spaces, copy the corresponding information from Section A.			FOR INSURANCE COMPANY USE
Building Street Address (including Apt., Unit, Suite, and/or Bldg. No.) or P.O. Route and Box No. 358 Pitch Landing Road			Policy Number:
City Conway	State South Carolina	ZIP Code 29527	Company NAIC Number
SECTION E – BUILDING ELEVATION INFORMATION (SURVEY NOT REQUIRED) FOR ZONE AO AND ZONE A (WITHOUT BFE)			
<p>For Zones AO and A (without BFE), complete Items E1–E5. If the Certificate is intended to support a LOMA or LOMR-F request, complete Sections A, B, and C. For Items E1–E4, use natural grade, if available. Check the measurement used. In Puerto Rico only, enter meters.</p> <p>E1. Provide elevation information for the following and check the appropriate boxes to show whether the elevation is above or below the highest adjacent grade (HAG) and the lowest adjacent grade (LAG).</p> <p>a) Top of bottom floor (including basement, crawlspace, or enclosure) is _____ <input type="checkbox"/> feet <input type="checkbox"/> meters <input type="checkbox"/> above or <input type="checkbox"/> below the HAG.</p> <p>b) Top of bottom floor (including basement, crawlspace, or enclosure) is _____ <input type="checkbox"/> feet <input type="checkbox"/> meters <input type="checkbox"/> above or <input type="checkbox"/> below the LAG.</p> <p>E2. For Building Diagrams 6–9 with permanent flood openings provided in Section A Items 8 and/or 9 (see pages 1–2 of Instructions), the next higher floor (elevation C2.b in the diagrams) of the building is _____ <input type="checkbox"/> feet <input type="checkbox"/> meters <input type="checkbox"/> above or <input type="checkbox"/> below the HAG.</p> <p>E3. Attached garage (top of slab) is _____ <input type="checkbox"/> feet <input type="checkbox"/> meters <input type="checkbox"/> above or <input type="checkbox"/> below the HAG.</p> <p>E4. Top of platform of machinery and/or equipment servicing the building is _____ <input type="checkbox"/> feet <input type="checkbox"/> meters <input type="checkbox"/> above or <input type="checkbox"/> below the HAG.</p> <p>E5. Zone AO only: If no flood depth number is available, is the top of the bottom floor elevated in accordance with the community's floodplain management ordinance? <input type="checkbox"/> Yes <input type="checkbox"/> No <input type="checkbox"/> Unknown. The local official must certify this information in Section G.</p>			
SECTION F – PROPERTY OWNER (OR OWNER'S REPRESENTATIVE) CERTIFICATION			
<p>The property owner or owner's authorized representative who completes Sections A, B, and E for Zone A (without a FEMA-issued or community-issued BFE) or Zone AO must sign here. The statements in Sections A, B, and E are correct to the best of my knowledge.</p>			
Property Owner or Owner's Authorized Representative's Name			
Address	City	State	ZIP Code
Signature	Date	Telephone	
Comments			
<input type="checkbox"/> Check here if attachments.			

ELEVATION CERTIFICATE

OMB No. 1660-0008
Expiration Date: November 30, 2022

IMPORTANT: In these spaces, copy the corresponding information from Section A.		FOR INSURANCE COMPANY USE
Building Street Address (including Apt., Unit, Suite, and/or Bldg. No.) or P.O. Route and Box No. 358 Pitch Landing Road		Policy Number:
City Conway	State South Carolina	ZIP Code 29527
SECTION G – COMMUNITY INFORMATION (OPTIONAL)		
The local official who is authorized by law or ordinance to administer the community's floodplain management ordinance can complete Sections A, B, C (or E), and G of this Elevation Certificate. Complete the applicable item(s) and sign below. Check the measurement used in Items G8–G10. In Puerto Rico only, enter meters.		
<p>G1. <input type="checkbox"/> The information in Section C was taken from other documentation that has been signed and sealed by a licensed surveyor, engineer, or architect who is authorized by law to certify elevation information. (Indicate the source and date of the elevation data in the Comments area below.)</p> <p>G2. <input type="checkbox"/> A community official completed Section E for a building located in Zone A (without a FEMA-issued or community-issued BFE) or Zone AO.</p> <p>G3. <input type="checkbox"/> The following information (Items G4–G10) is provided for community floodplain management purposes.</p>		
G4. Permit Number	G5. Date Permit Issued	G6. Date Certificate of Compliance/Occupancy Issued
<p>G7. This permit has been issued for: <input type="checkbox"/> New Construction <input type="checkbox"/> Substantial Improvement</p> <p>G8. Elevation of as-built lowest floor (including basement) of the building: _____ <input type="checkbox"/> feet <input type="checkbox"/> meters Datum _____</p> <p>G9. BFE or (in Zone AO) depth of flooding at the building site: _____ <input type="checkbox"/> feet <input type="checkbox"/> meters Datum _____</p> <p>G10. Community's design flood elevation: _____ <input type="checkbox"/> feet <input type="checkbox"/> meters Datum _____</p>		
Local Official's Name		Title
Community Name		Telephone
Signature		Date
<p>Comments (including type of equipment and location, per C2(e), if applicable)</p> <div style="text-align: right; font-size: x-small;"> <input type="checkbox"/> Check here if attachments. </div>		

BUILDING PHOTOGRAPHS

ELEVATION CERTIFICATE

See Instructions for Item A6.

OMB No. 1660-0008
Expiration Date: November 30, 2022

IMPORTANT: In these spaces, copy the corresponding information from Section A.			FOR INSURANCE COMPANY USE
Building Street Address (including Apt., Unit, Suite, and/or Bldg. No.) or P.O. Route and Box No. 358 Pitch Landing Road			Policy Number:
City Conway	State South Carolina	ZIP Code 29527	Company NAIC Number

If using the Elevation Certificate to obtain NFIP flood insurance, affix at least 2 building photographs below according to the instructions for Item A6. Identify all photographs with date taken; "Front View" and "Rear View"; and, if required, "Right Side View" and "Left Side View." When applicable, photographs must show the foundation with representative examples of the flood openings or vents, as indicated in Section A8. If submitting more photographs than will fit on this page, use the Continuation Page.



Photo One

Photo One Caption Front View Taken 09-07-2021

Clear Photo One



Photo Two

Photo Two Caption Rear View Taken 09-07-2021

Clear Photo Two

ELEVATION CERTIFICATE

BUILDING PHOTOGRAPHS

Continuation Page

OMB No. 1660-0008
Expiration Date: November 30, 2022

IMPORTANT: In these spaces, copy the corresponding information from Section A.			FOR INSURANCE COMPANY USE
Building Street Address (including Apt., Unit, Suite, and/or Bldg. No.) or P.O. Route and Box No. 358 Pitch Landing Road			Policy Number:
City Conway	State South Carolina	ZIP Code 29527	Company NAIC Number

If submitting more photographs than will fit on the preceding page, affix the additional photographs below. Identify all photographs with: date taken; "Front View" and "Rear View"; and, if required, "Right Side View" and "Left Side View." When applicable, photographs must show the foundation with representative examples of the flood openings or vents, as indicated in Section A8.



Photo Three

Photo Three Caption Left View Taken 09-07-2021

Clear Photo Three



Photo Four

Photo Four Caption Right View Taken 09-13-2021

Clear Photo Four



APPROVAL TO OPERATE
Onsite Wastewater System

File Nbr: **2017030024**
County: **Horry**

Name: **ALTON CLORE** Address: **PO BOX 8420** Program Code: **362**
Type Facility: **HOUSE** MYRTLE BEACH, SC 29578 Tax Map: **38103010001**
Subdivision: Site: **358 PITCH LANDING RD** Water Supply: **PUBLIC**
Block: Lot: CONWAY, SC

ACTUAL INSTALLATION (NTS)

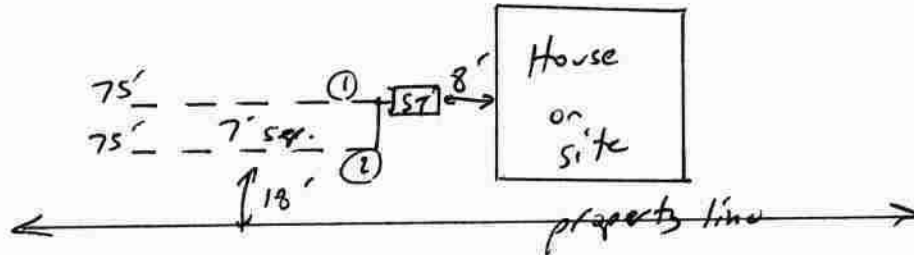

FINAL APPROVAL

Installer: Joey Brown
Septic Tank Mfg: CDI/krill
Pump Chbr Mfg: n/a
Pump Mfg: n/a
Pump Model: n/a
Grease Trap Mfg: n/a
Aggregate: fire chips
Trench Dpth (in): 15" → 21"
System Code: 220
Well Installed: N/A
Well Dist (ft): N/A
Building Dist (ft): 8'
Property Dist (ft): 18'
Water Dist (ft): N/A

Elevation Readings
Stubout: NIP S/T Inlet: 4' 1 3/4" S/T outlet: 4' 3 3/4"

Line No.			
①	4' 6 3/4"	4' 7"	4' 7"
②	4' 6 3/4"	4' 6 3/4"	4' 7"

GPS Latitude:
Longitude:
Accuracy:

Comments: Do not drive or park on system.

Licensed Installer Printed Name: Joey Brown License #: 210118

I hereby certify the system was installed in accordance with the referenced permit and R.61-56 and is in an exposed condition ready for inspection.

Licensed Installer Signature: [Signature] Date: 9/19/17

APPROVAL BY DHEC TO OPERATE

THIS CERTIFICATE OF FINAL APPROVAL IN NO WAY GUARANTEES THE LIFE OF THE SYSTEM OR THAT IT WILL FUNCTION PROPERLY UNDER ANY OR ALL CONDITIONS

Approved By: [Signature] Adam Lesley Date: 9-19-17
843-915-8301